

# Splice Plates - Ladder Cable Tray

Enduro offers a full line of fiberglass splice plates designed to provide a structural transition between straight sections and fittings. Enduro splice plates and hardware are sold separately and are not provided as standard with straight sections or fittings due to the many hardware options. All plates have 7/16" pre-drilled bolt holes.

## NEMA FG-1

Please refer to NEMA FG-1 regarding proper tray installation as it pertains to support and splice plate locations for straight sections and fittings. Refer to page 11 for recommended support locations. **NEMA**

## Ladder Cable Tray Splice Plate Part Numbers

Example: **ESP - 6C - 180**

| Type             | Side Rail Height  | Material                      | Degree                    |
|------------------|-------------------|-------------------------------|---------------------------|
| ESP = Straight   | 3 = 3" (75mm)*    | C = Polyester                 | 180 = Straight, Expansion |
| EEXP = Expansion | 4 = 4" (100mm)*   | V = Vinyl Ester               | 90 = 90°                  |
| EVS = Vertical   | 6 = 6" (150mm)*   | SS = Stainless Steel          | 45 = 45°                  |
| EHS = Horizontal | 8 = 8" (200mm)*   | ✓ Conductive                  | 30 = 30°                  |
|                  | 10 = 10" (250mm)* | ✓ Halogen-Free                | 22.5 = 22.5°              |
|                  |                   | ✓ Halogen-Free Low Smoke Plus | HA = Horiz. Adjustable**  |
|                  |                   |                               | VA = Vert. Adjustable**   |

✓ = For Conductive and Halogen-Free formulations, please contact us for product codes. \* (mm) value is nominal. \*\* For Horiz. and Vert. Adjustable part number use "ESP" for Type, example: ESP-6C-HA. Expansion plates have 1" slotted holes allowing 5/8" total contraction and expansion. Refer to thermal contraction table on page 6 for maximum spacing between expansion joints. Side rail height of 3" and 4" comes with 4 bolt sets per plate. Side rail height of 6" and 8" comes with 8 bolt sets per plate. Side rail height of 10" comes with 12 bolt sets per plate. For 6" and 8" channel heavy duty splice plates, see page 22.

## Splice and Hardware Options

| Tray Resin                  | Splice Material |             |                     | Hardware Sets       |          |                |          |
|-----------------------------|-----------------|-------------|---------------------|---------------------|----------|----------------|----------|
|                             | Polyester       | Vinyl Ester | 316 Stainless Steel | 316 Stainless Steel | Monel    | Silicon Bronze | Isoplast |
| Polyester                   | Standard        | Optional    | Optional            | Standard            | Optional | Optional       | Optional |
| Vinyl Ester                 |                 | Standard    | Optional            | Standard            | Optional | Optional       | Optional |
| Halogen-Free                |                 | Optional    | Standard            | Standard            | Optional | Optional       | Optional |
| Halogen-Free Low Smoke Plus |                 |             | Standard            | Standard            | Optional | Optional       | Optional |
| Conductive                  |                 |             | Standard            | Standard            | Optional | Optional       | Optional |

## Hardware

| Type                         | Set Includes                             | Size             | For Use With Tray Types                | Part No. |
|------------------------------|--|------------------|--|----------|
| 316 Stainless Steel Bolt Set | Bolt, nut, 2 flat washers, 1 lock washer | 3/8"-16 x 1 1/4" | All tray types (except 10" Channel***) | 505167SS |
| 316 Stainless Steel Bolt Set | Bolt, nut, 2 flat washers, 1 lock washer | 3/8"-16 x 1 1/2" | All tray types (except 10" Channel***) | 505168SS |
| Monel Bolt Set               | Bolt, nut, 2 flat washers, 1 lock washer | 3/8"-16 x 1 1/4" | All tray types (except 10" Channel***) | 606167M  |
| FRP Studs & Nuts             | Stud and 2 nuts                          | 3/8"-16 x 2"     | ELL3, ELL4, ELL6, EIL6, EMZ6           | 707166F  |
| FRP Studs & Nuts             | Stud and 2 nuts                          | 3/8"-16 x 2 1/2" | EHL6, EHL8, EHV6                       | 707167F  |
| Silicon Bronze Bolt Set      | Bolt, nut, 2 flat washers, 1 lock washer | 3/8"-16 x 1 1/4" | All tray types (except 10" Channel***) | 808167SB |

\*\*\* Contact us for hardware; It is recommended that expansion splice plates and 1 1/4" long assembly fasteners be used when connecting mitered fittings to molded fittings or straight lengths.

## Typical Dimensions for FRP Splice Plates

| Typical Dimensions Inches (mm) |             |              |            |
|--------------------------------|-------------|--------------|------------|
| Channel Depth Inches (mm)      | A           | B            | C          |
| 3 (76)                         | 1 3/4 (44)  | 1 (25)       | -0-        |
| 4 (102)                        | 2 (51)      | 1 (25)       | -0-        |
| 6 (152)                        | 4 5/8 (117) | 1 (25)       | 2 5/8 (67) |
| 8 (203)                        | 6 (152)     | 1 11/16 (43) | 2 5/8 (67) |

## Typical Dimensions for Stainless Splice Plates

| Typical Dimensions Inches (mm) |             |          |            |
|--------------------------------|-------------|----------|------------|
| Channel Depth Inches (mm)      | A           | B        | C          |
| 3 (76)                         | 1 1/4 (32)  | 5/8 (16) | -0-        |
| 4 (102)                        | 1 1/4 (32)  | 5/8 (16) | -0-        |
| 6 (152)                        | 4 1/8 (105) | 3/4 (19) | 2 5/8 (67) |
| 8 (203)                        | 4 1/8 (105) | 3/4 (19) | 2 5/8 (67) |

# Ladder Cable Tray - Splice Plates

## Straight Section

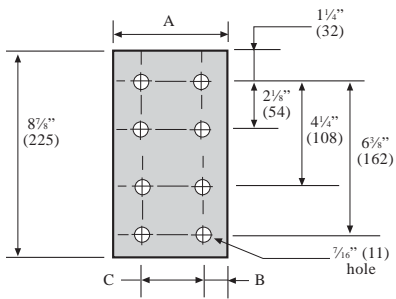

## Expansion

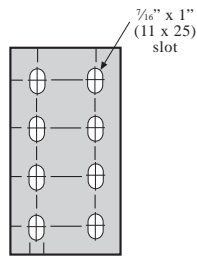

## 90° Vertical

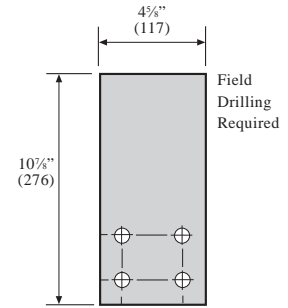

## 45° Vertical

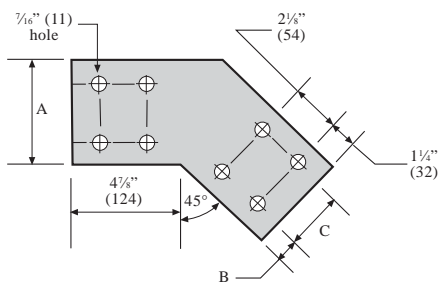

## 30° Vertical

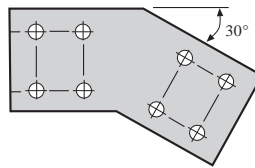

## 22.5° Vertical

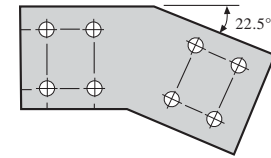

## Adjustable Vertical

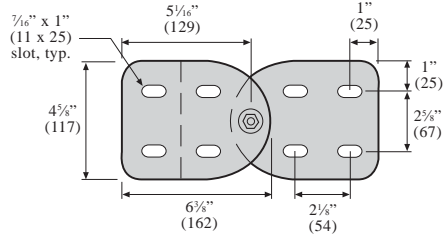

For adjustable vertical plate hardware, use catalog number 505168SS. For travel dimensions, contact us.

## 90° Horizontal

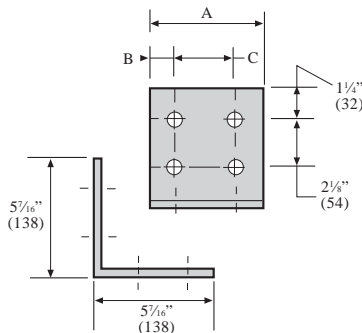

## 45° Horizontal

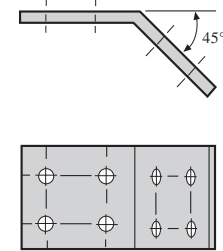

## 30° Horizontal

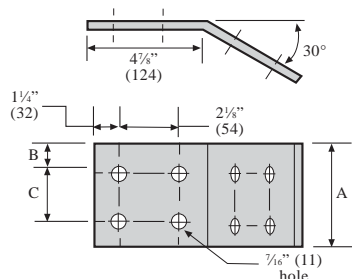

## 22.5° Horizontal

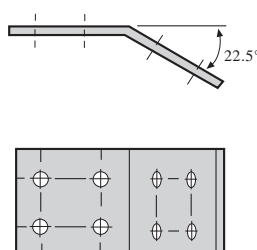

## Adjustable Horizontal

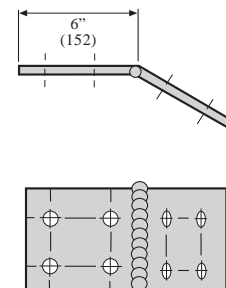

# Splice Plates - Ladder Cable Tray

## Heavy Duty Splice Plates

**Part No. Key\***  
ESP-(H) HP-180 Splice Plate

**Part No. Key\***  
EEP-(H) HP-180 Splice Plate

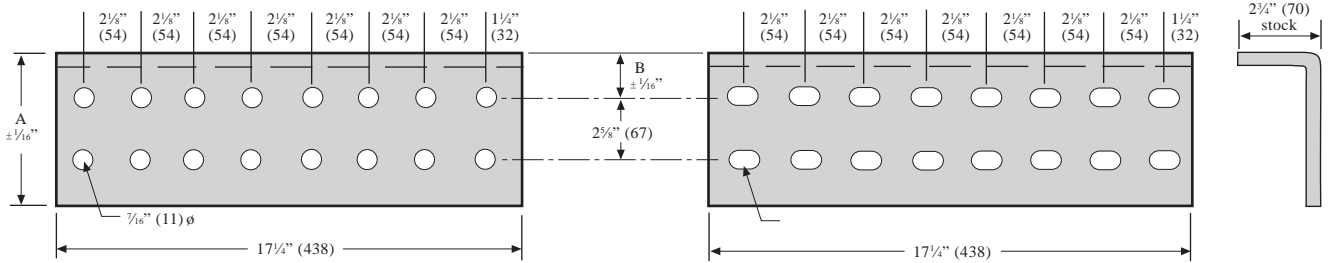

| Side Rail Height<br>Inches<br>(mm) | A<br>Inches<br>(mm) | B<br>Inches<br>(mm) |
|------------------------------------|---------------------|---------------------|
| 4 (102)                            | 3 (76)              | 1 3/8 (35)          |
| 6 (152)                            | 5 (127)             | 1 3/8 (35)          |
| 8 (204)                            | 6 3/8 (162)         | 2 1/16 (52)         |

Splice Plates

## 10" Channel Splice Plates

**Part No.**  
ESP-10C-180 Splice Plate

**Part No.**  
EEP-10C-180 Splice Plate

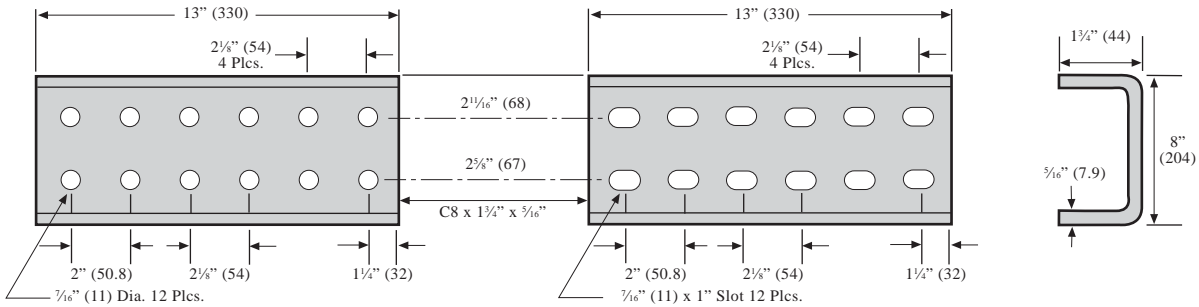

\* In Part No. Key, parentheses ( ) = insert corresponding option code; H = Side Rail Height - 4, 6, 8 (inches)